

Conventional Gas Lift Mandrel

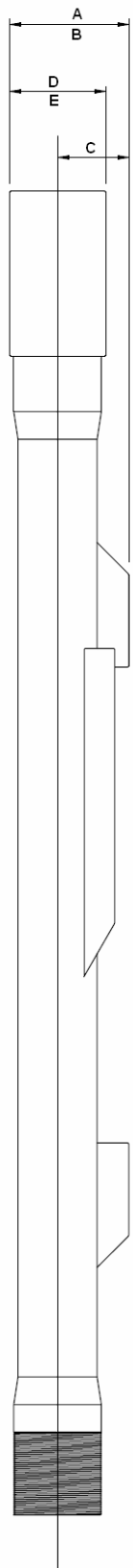

Tejas offers 1” spring loaded production-pressure-operated gas lift valves suitable for use in continuous flow gas lift installations. The valves feature a multi-ply Monel bellows with valve bodies available in Monel and stainless steel. All valves have an integral reverse flow check valve. These valves are recommended for use in dual completions where gas lift is applied to both strings.





Valve Size – 1”

	2.375” O.D. 2” Nominal	2.875” O.D. 2-1/2” Nominal
API EUE	A – 3.783	A – 4.335
	B – 3.706	B – 4.231
	C – 2.251	C – 2.501
	D – 3.063	D – 3.668
	E – 2.910	E – 3.460
	2.375” O.D. 2” Nominal	2.875” O.D. 2-1/2” Nominal
API NUE	A – 3.689	A – 4.251
	B – 3.586	B – 4.119
	C – 2.251	C – 2.501
	D – 2.875	D – 3.500
	E – 2.670	E – 3.235

Valve Size – 1-1/2”

	2.375” O.D. 2” Nominal	2.875” O.D. 2-1/2” Nominal	3.500” O.D. 3” Nominal
API EUE	A – 4.283	A – 4.835	A – 5.562
	B – 4.206	B – 4.731	B – 5.427
	D – 3.063	D – 3.668	D – 4.500
	E – 2.910	E – 3.460	E – 4.230
		2.375” O.D. 2” Nominal	2.875” O.D. 2-1/2” Nominal
API NUE	A – 4.189	A – 4.751	A – 5.262
	B – 4.086	B – 4.619	B – 5.152
	D – 2.875	D – 3.500	D – 4.250
	E – 2.670	E – 3.235	E – 4.030

Dimensions in inches

- A – Lug to collar
- B – Lug to collar (special clearance)
- C – Lug to centerline of tubing
- D – Collar diameter
- E – Collar diameter (special clearance)